



Brief and handy:  
everything your  
dishwasher needs ...  
**Before using for the first time,  
read the operating instructions!**

1

Adjusting the water softening system \*

Ask your water  
supply company  
what the water  
hardness is and  
enter ...

\* only before the first  
wash or if the water  
hardness has been  
changed

Water- hardness- value °E	Hardness- range	mmol/l	Factory- setting
0-8	soft	0-1.1	0-8
9-10	soft	1.2-1.4	9-10
11-12	medium	1.5-1.8	11-12
13-15	medium	1.9-2.1	13-15
16-20	medium	2.2-2.9	16-20
21-26	hard	3.0-3.7	21-26
27-38	hard	3.8-5.4	27-38
39-62	hard	5.5-8.9	39-62

Quickly sorted ...

How to adjust

- Open the door
- Switch on ON/OFF switch
- Press Info button for 3 seconds until the following text is indicated on the display window at the top:  
**Scroll with < >**  
**Set with - +**  
**Leave with Setup 3 sec.**
- Keep pressing button > until the water hardness is indicated on the display window at the top.
- Make the setting with setting buttons + -.
- Press and hold the Info button for 3 seconds.  
The chosen setting has now been stored.

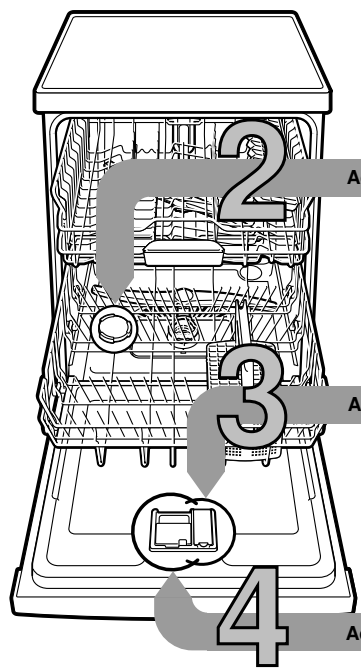

Add special salt

Dissolves limescale (not necessary for set value 0!) ...

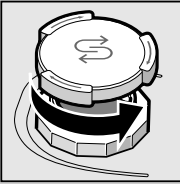

Unscrew  
cover.

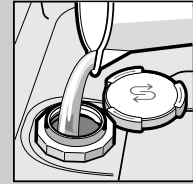

Fill the salt  
dispenser with  
water before  
the first wash only.

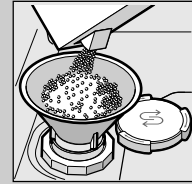

Add special salt  
(never add  
detergent!).

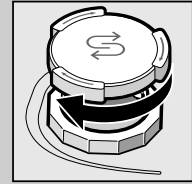

Screw on  
the cover.  
Wash  
immediately.

Add rinse aid

Spick and span ...

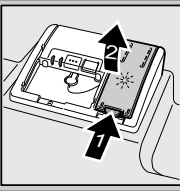

Press  
mark 1,  
lift up  
cover 2.

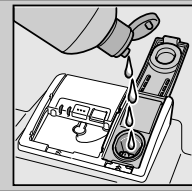

Fill in  
rinse aid.

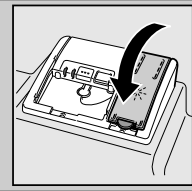

Screw on  
the cover.  
CLICK!

Add detergent

A lot of dirt, a lot of detergent ...

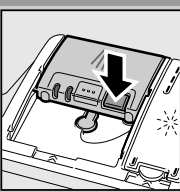

If required,  
open the cover  
(press button).



Attention:  
Combination  
products  
are not suitable  
for all programmes,  
follow  
manufacturer's  
instructions.

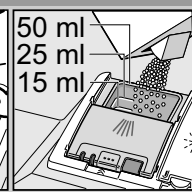
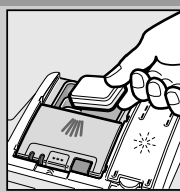

Pour detergent  
into the dry  
detergent  
dispenser only.

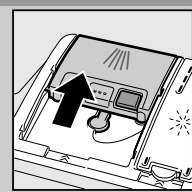

Slide cover  
shut, press.  
PLOP!

Switch on the appliance

Select a programme

Quick, economical or intensive ...

Overview of programmes

The max. possible number of programmes is illustrated in this overview. The corresponding programmes for your appliance can be found on the fascia. The programme data has been measured in the laboratory according to European standard EN 50242. Deviations are possible in practice

\* half normal load  
\*\* Programme which is suitable for the night:  
prolonged running time, but very quiet.

	Intensive 70°	Auto 65° / 75°	Auto 45° / 65°	Eco 50°	Auto 35° / 45°	Glass 40°	Night **	Quick wash 45°	Prerinse
Duration: hs/mins	2:15	1:40 - 2:15	1:30 - 2:40	3:30	1:05 - 1:20	1:30	4:00	0:29 *	0:15
Energy consumption in kWh	1,50	1,30 - 1,60	0,95 - 1,60	0,90 - 0,93	0,70 - 0,85	0,90	1,09	0,80	0,05
Water consumption in litres	12 - 15	11 - 15	7 - 18	9,5	10 - 15	11 - 14	10	10	4

Switch on the appliance Here we go ...

Switch off the appliance Everything o.k. ...

Maintenance and care

Filters  
... check,  
if required,  
clean.

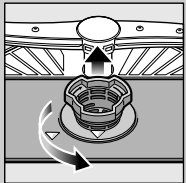

Rotate  
filter cylinder,  
remove filter  
system ...



rinse  
under  
running  
water ...

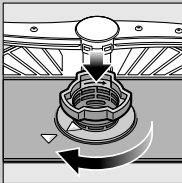

insert ...

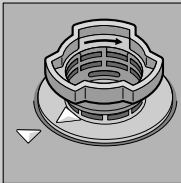

Screw on  
filter system  
**NOTE  
MARK!**

Cleaning waste water pump

- Pull out the mains plug.
- Remove filters and scoop out water.
- Lever off cover (A).
- Check area around the fan impeller for foreign objects.
- Click cover shut (B).
- Insert filters.

Spray arms  
... Remove  
blockages/  
deposits.

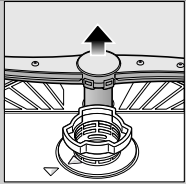

pull lower arm  
upwards ...

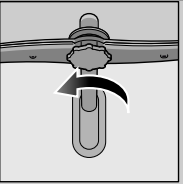

unscrew  
upper arm ...

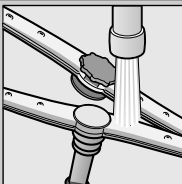

clean spray nozzles  
under running water  
(if required  
use toothpicks) ...

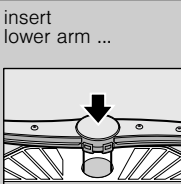

insert  
lower arm ...

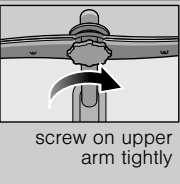

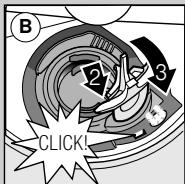
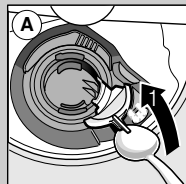

screw on upper  
arm tightly



Rectifying minor faults yourself ...

... as it is worth doing it yourself!

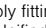
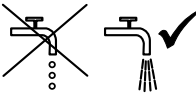
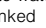
More information can be found in the operating instructions

Fault	Possible causes	Remedial action
Display “  ” is lit	Supply fitting jammed or calcified 	<ul style="list-style-type: none"><li>▶ Open supply fitting.</li><li>▶ 1. Unscrew water connection.</li><li>▶ 2. Clean filter in the water connection.</li><li>▶ 3. Flow rate must be min. 10 l/min., when water supply is open.</li><li>▶ If the flow rate is less, replace the supply fitting.</li><li>▶ Install supply hose without kinks.</li></ul>
Display “E:22”	Filters are soiled or blocked	<ul style="list-style-type: none"><li>▶ Clean the filters (see above).</li></ul>
Display “E:24” and “  ” are lit*	Waste water hose is blocked or kinked Cover not attached to waste water pump	<ul style="list-style-type: none"><li>▶ Install waste water hose without kinks.</li><li>▶ Attach cover (see above).</li></ul>
Display “E:25” and “  ” are lit*	Waste water pump blocked	<ul style="list-style-type: none"><li>▶ Clean waste-water pump (see above).</li></ul>
Other fault display “E:XX” is lit	Appliance has technical defect	<ul style="list-style-type: none"><li>▶ Call factory customer service (state fault display).</li><li>▶ Unplug appliance.</li></ul>
Residual water in the appliance	The programme has not yet ended	<ul style="list-style-type: none"><li>▶ Switch on and close the appliance or terminate the programme (see Terminating the programme).</li></ul>
Rust on the cutlery	Cutlery not rust-resistant Hard knife blades are more susceptible Extraneous rust	<ul style="list-style-type: none"><li>▶ Use dishwasher-proof cutlery.</li><li>▶ Never wash rusting parts in the appliance.</li></ul>

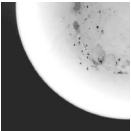
Fault	Possible causes	Remedial action
Utensils are not clean	Utensils are situated close together or one above the other	<ul style="list-style-type: none"><li>▶ Separate the utensils, prevent contact points.</li></ul>
Sand or gritty residue on the utensils 	Too little detergent Unsuitable programme selected Spray arm nozzles blocked Filters dirty, not seated firmly Spray arms blocked	<ul style="list-style-type: none"><li>▶ Follow manufacturer's instructions (detergent).</li><li>▶ Select a more intensive programme.</li><li>▶ Clean the spray arms (see above).</li><li>▶ Clean the filters (see above).</li><li>▶ Arrange the utensils so that the spray arms can rotate freely.</li></ul>
Stains and streaks	Rinse aid dosage too high/ too low	<ul style="list-style-type: none"><li>▶ Streaks: reduce dosage.</li><li>▶ Water or limescale stains: increase dosage.</li></ul>
Utensils not dry	Rinse aid The combined detergent used has a poor drying performance Appliance setting	<ul style="list-style-type: none"><li>▶ Increase dosage.</li><li>▶ Change the product.</li><li>▶ Use rinse aid.</li><li>▶ Activate intensive drying (depending on model).</li></ul>
Milky deposits on the utensils (can be removed)	Water softening system incorrectly set No salt	<ul style="list-style-type: none"><li>▶ Correctly set water softening system.</li><li>▶ Refill with special salt.</li></ul>
Milky deposits, glasses cloudy/tarnished (cannot be removed)	Glasses not dishwasher-proof	<ul style="list-style-type: none"><li>▶ Use dishwasher-proof glasses.</li><li>▶ Use a detergent suitable for glasses.</li></ul>
Plastic/utensils discoloured	Too little detergent Discoloration caused by food colourings (tomato sauce)	<ul style="list-style-type: none"><li>▶ Follow manufacturer's instructions (detergent).</li><li>▶ Discoloration is harmless; subsequent rinse cycles will cause it to fade.</li></ul>

\* depending on model

Terminating the programme ...

Open the door.  
Press the start button and hold  
for 3 seconds (Reset).



The display window shows:  
Program was terminated.  
Close the door.



The programme sequence lasts approx. 1 min.  
The display window shows:  
Finished.  
Open the door.  
Switch off ON/OFF switch.

Loading the dishwasher correctly ...

Dishwasher-proof utensils (not soiled with ash, wax, lubricating grease, ink or adhesive labels;  
remove large remnants of jam, milk products and food according to the operating instructions  
and check that the spray arms can rotate freely.