

Installation drawings

Whether you want to replace a household appliance or planning a kitchen - here you will find all the relevant installation diagrams for your Miele appliance.

If you want to download an installation diagram, please click on the appropriate image and the high-resolution version is displayed. To download, click the right mouse button and save the image on your computer.

Please note that the installation and maintenance of our equipment should only be performed by a licensed contractor. For questions, please call us and we will advise you without any obligation!

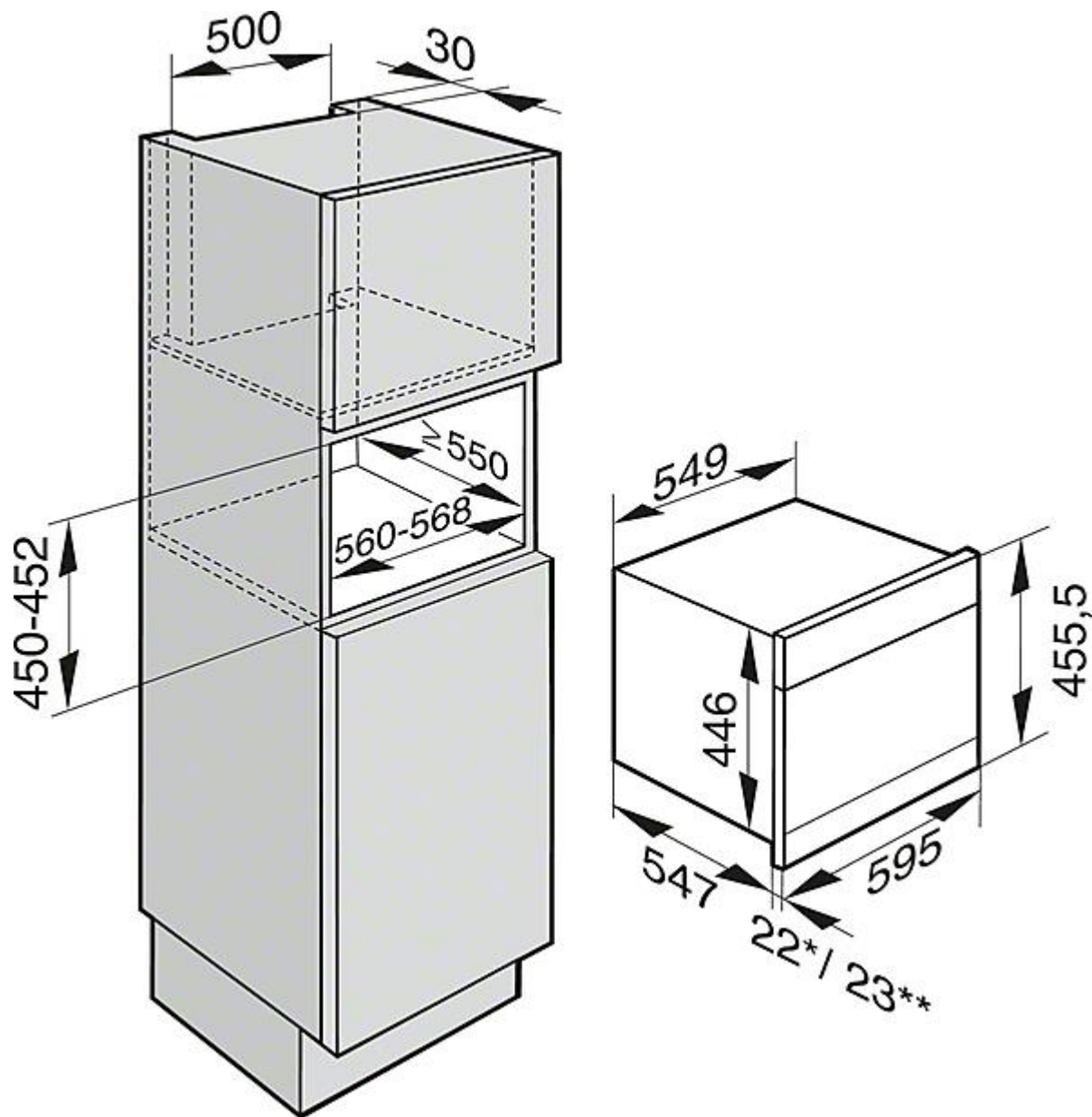

Descriptions

DGC 6300, DGC 6400, in a tall unit, CLST (Installation drawing)

* Appliances with glass front

** Appliances with metal front

The socket has to be accessible once the appliance has been installed

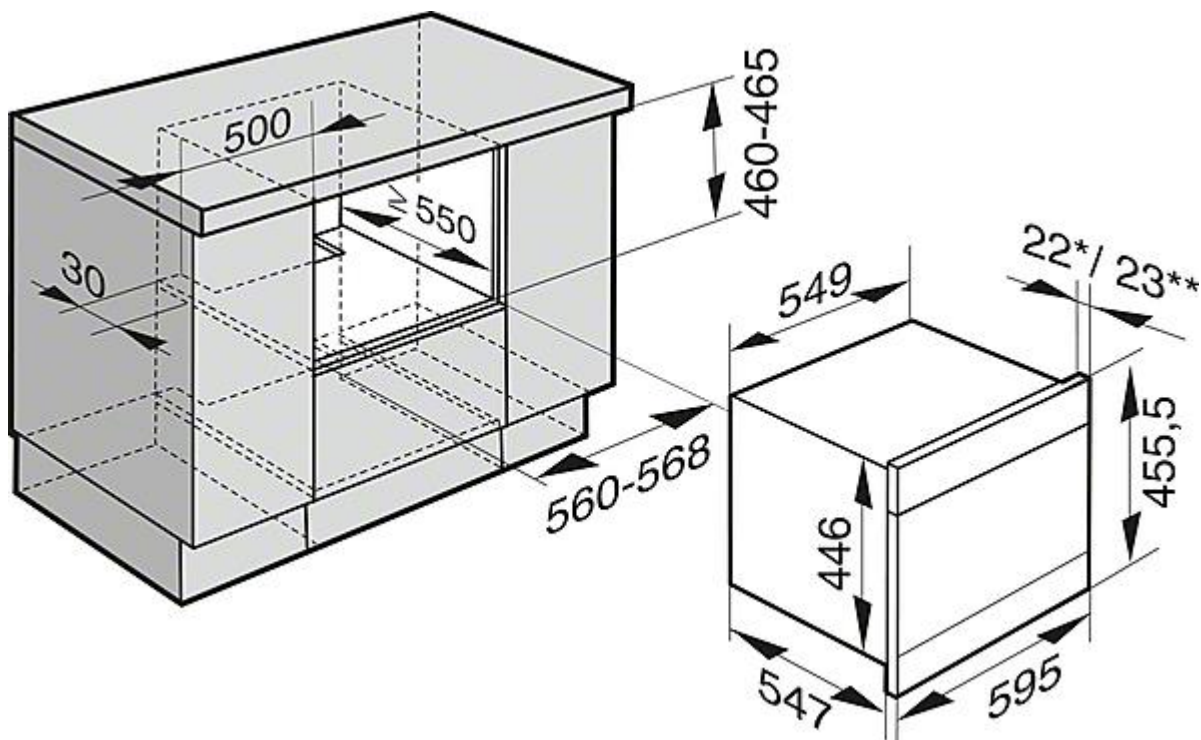

Descriptions

DGC 6300, DGC 6400, in a floor unit, CLST (Installation drawing)

* Appliances with glass front

** Appliances with metal front

The socket has to be accessible once the appliance has been installed

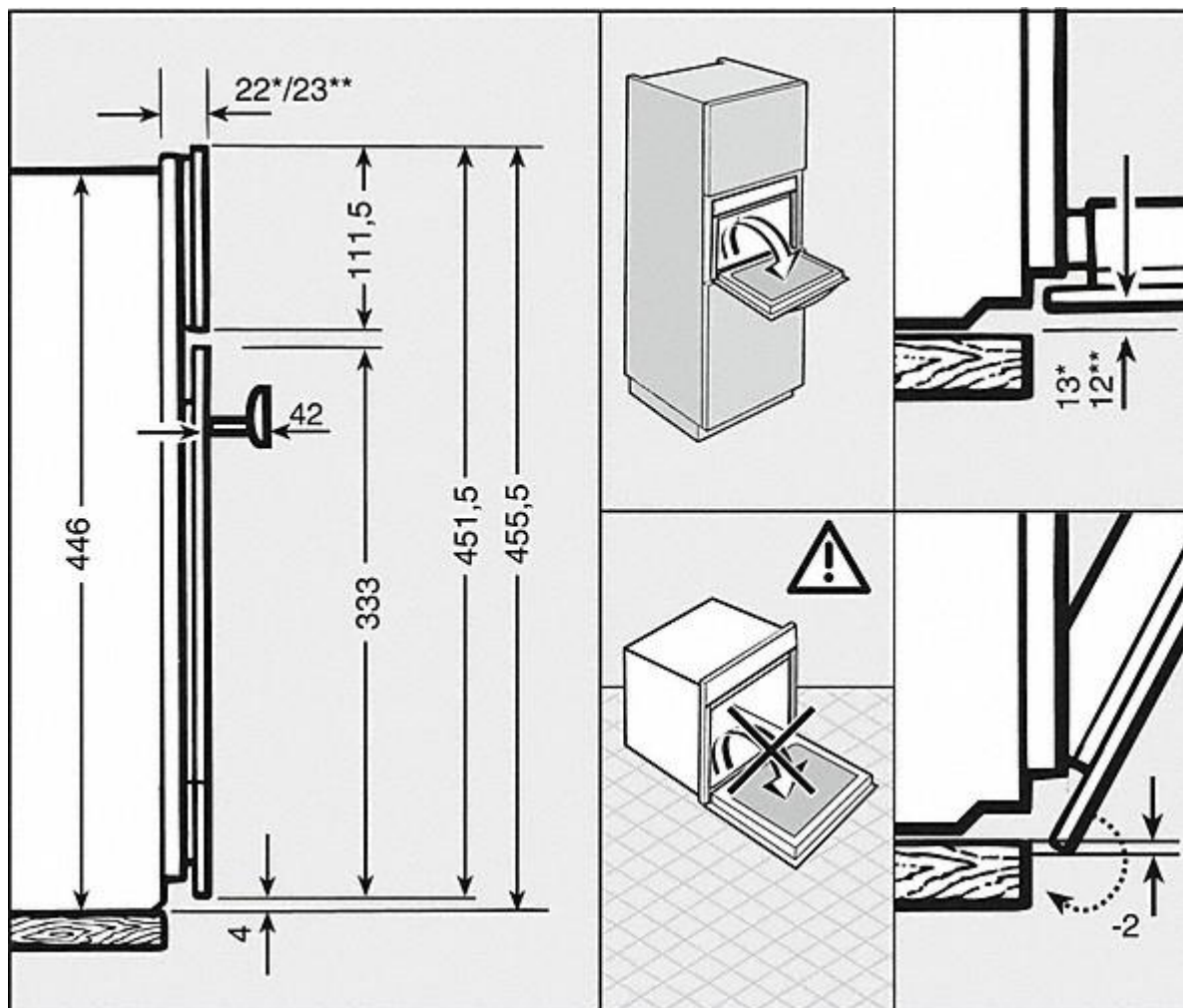

Descriptions

DGC 6400 - detailed installations drawing for PureLine (Installation drawing)

* Appliances with glass front

** Appliances with metal front